

- Fixed Gantry CNC Router
- 1,200 IPM Maximum Feed Speed, Engineered steel Construction, Track ways and AC servos

- 10 HP, 24,000 RPM High Frequency Spindle with "Bar Style" automatic tool changer, 2 tool holders, 3 collets, 3 Cabinet Router bits and spoilboard router tool. - Additional Options Pg. 8-10

- eCabinet Systems cabinet design software and Rolling Nest software with label and nest printers.

- Aluminum Moving 49" x 97" Table with Ball Screw Drives. Integrated 2100 CFM Impeller Vacuum System, manual pop-up pins and sheet of MDF vacuum spoilboard.

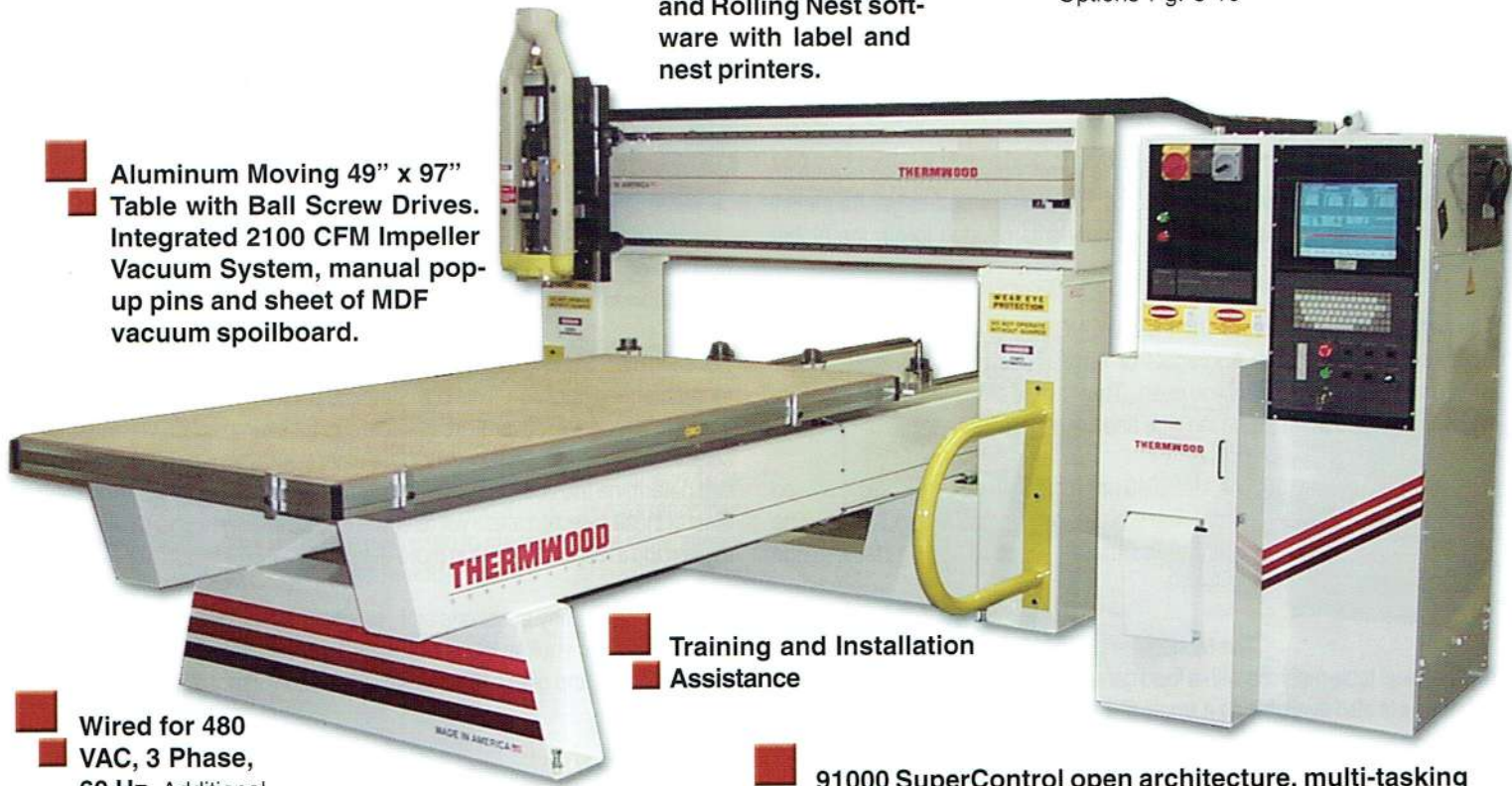

- Training and Installation Assistance

- Wired for 480 VAC, 3 Phase, 60 Hz- Additional Options Pg. 9

- 91000 SuperControl open architecture, multi-tasking CNC control with network card, CD Rom Drive, 1 year Advanced Support Program and Virtual Service. (Requires a direct phone line to machine control)- Additional Options Pg. 24-25

CabinetShop 40

49" x 97" table

Base Price \$64,950

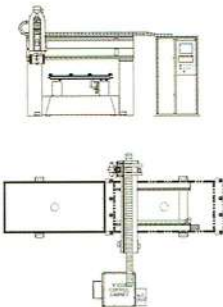

Additional Table Sizes

- For 5' x 8' Table ADD \$2,950
- For 5' x 10' Table ADD \$6,000

CabinetShop 40

Dimensions:
 49" x 97" table - 85"H x 89"W x 212"L
 5' x 8' table - 85"H x 95"W x 200"L
 5' x 10' table - 85"H x 95"W x 248"L

The CabinetShop 40 is a complete system for machining nested based cabinets. Combined with eCabinet Systems, the CabinetShop 40 will seamlessly nest, print part identification labels and machine cabinet boxes from full sheets. For more information about the eCabinet Systems software refer to Pg. 26 or visit our website eCabinetSystems.com